

# GHC 100-400-2

Curvas Características  
Characteristic Curves  
Courbes Caractéristiques

# 960

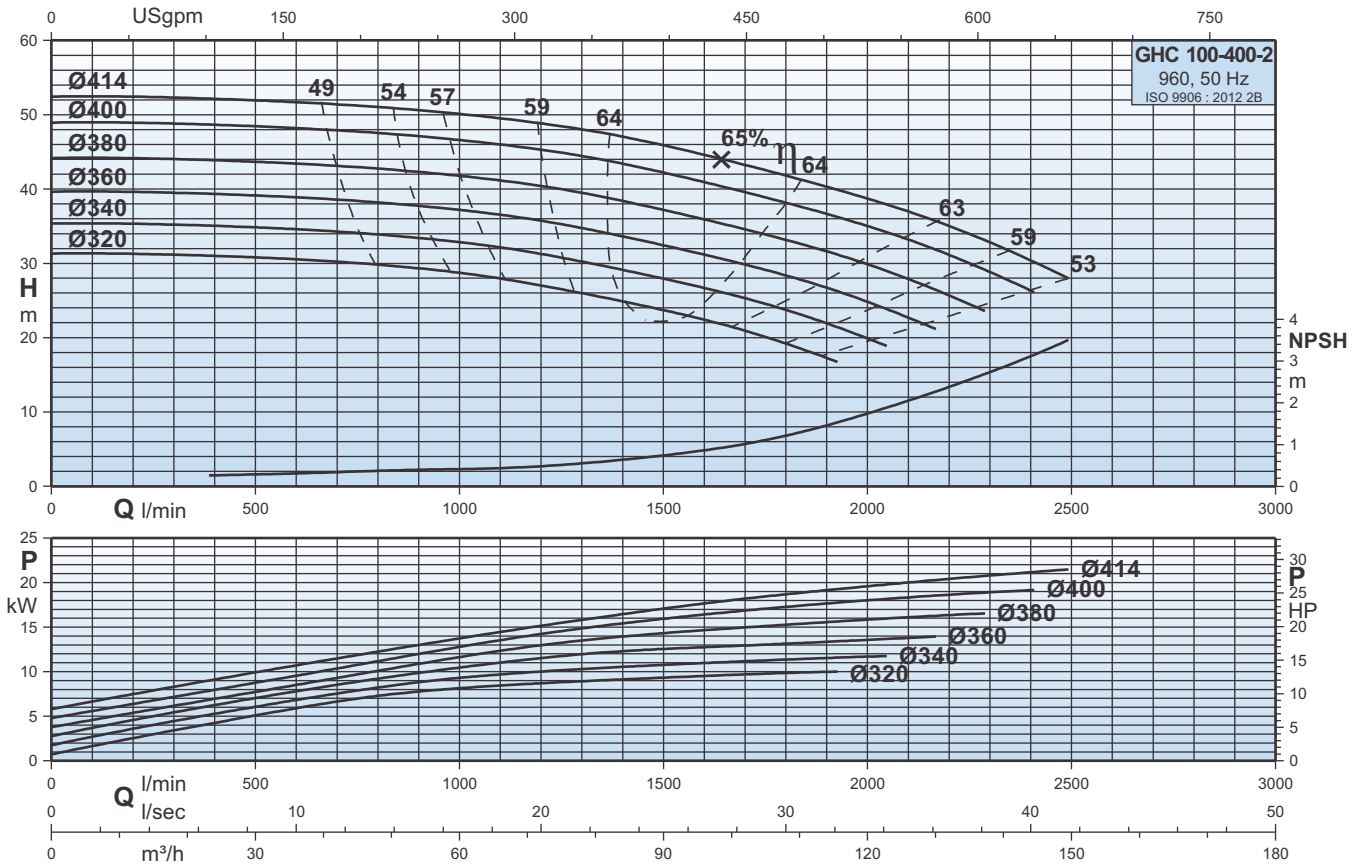

# GHC 125-400-2

Curvas Características  
Characteristic Curves  
Courbes Caractéristiques

# 960

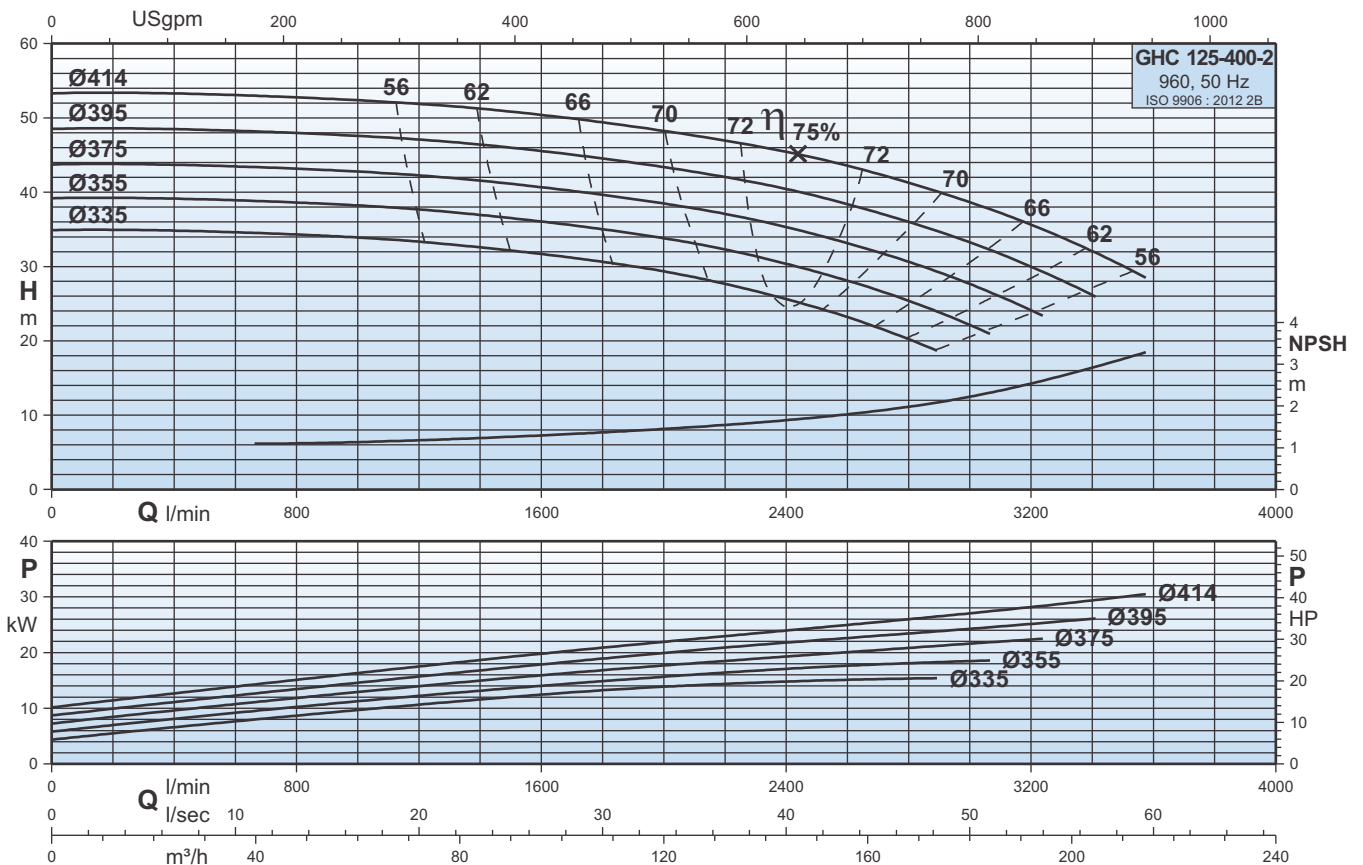

# GHC 150-315

Curvas Características  
Characteristic Curves  
Courbes Caractéristiques

# 960

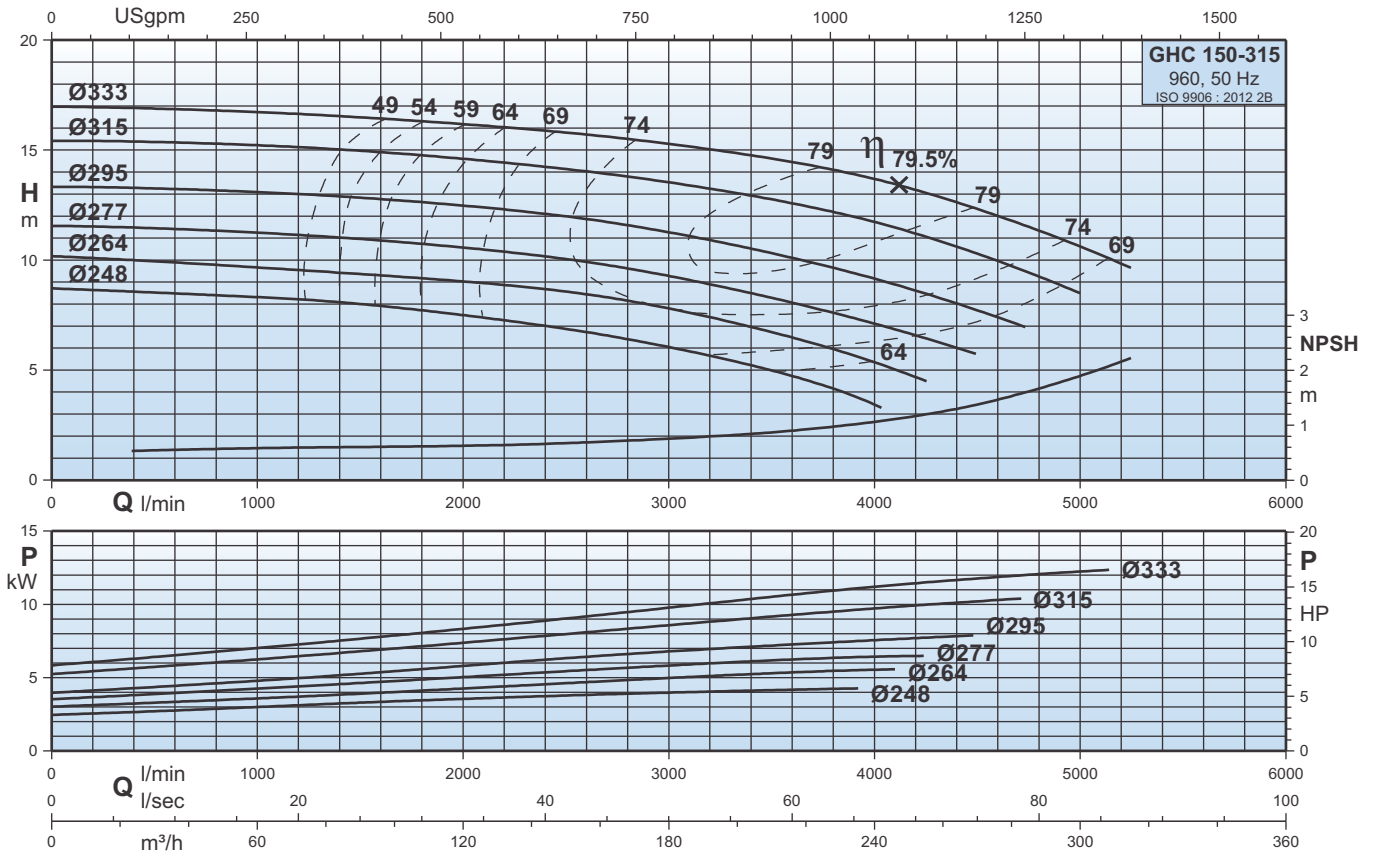

# GHC 150-400

Curvas Características  
Characteristic Curves  
Courbes Caractéristiques

# 960

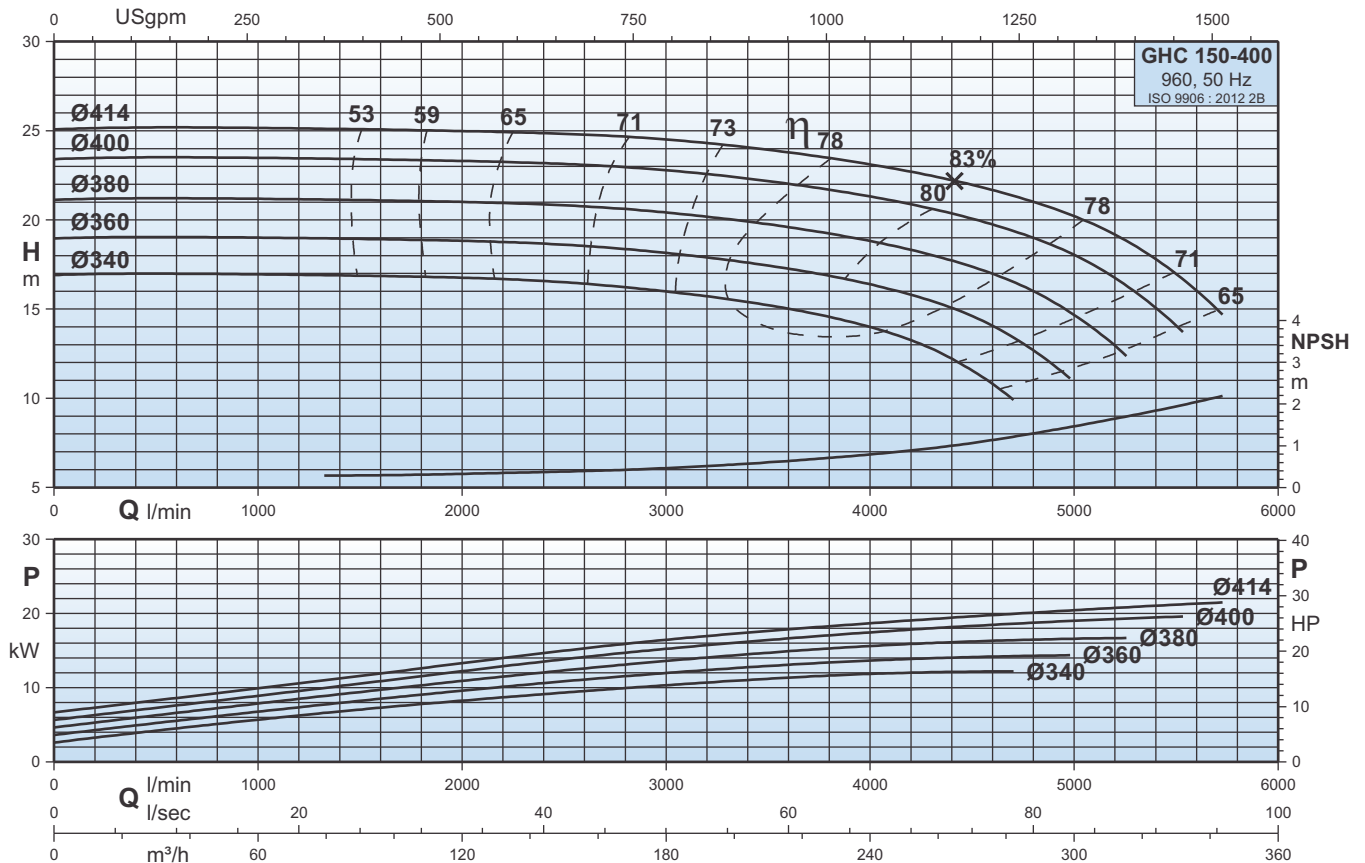

# GHC 150-440-2

Curvas Características  
Characteristic Curves  
Courbes Caractéristiques

# 960

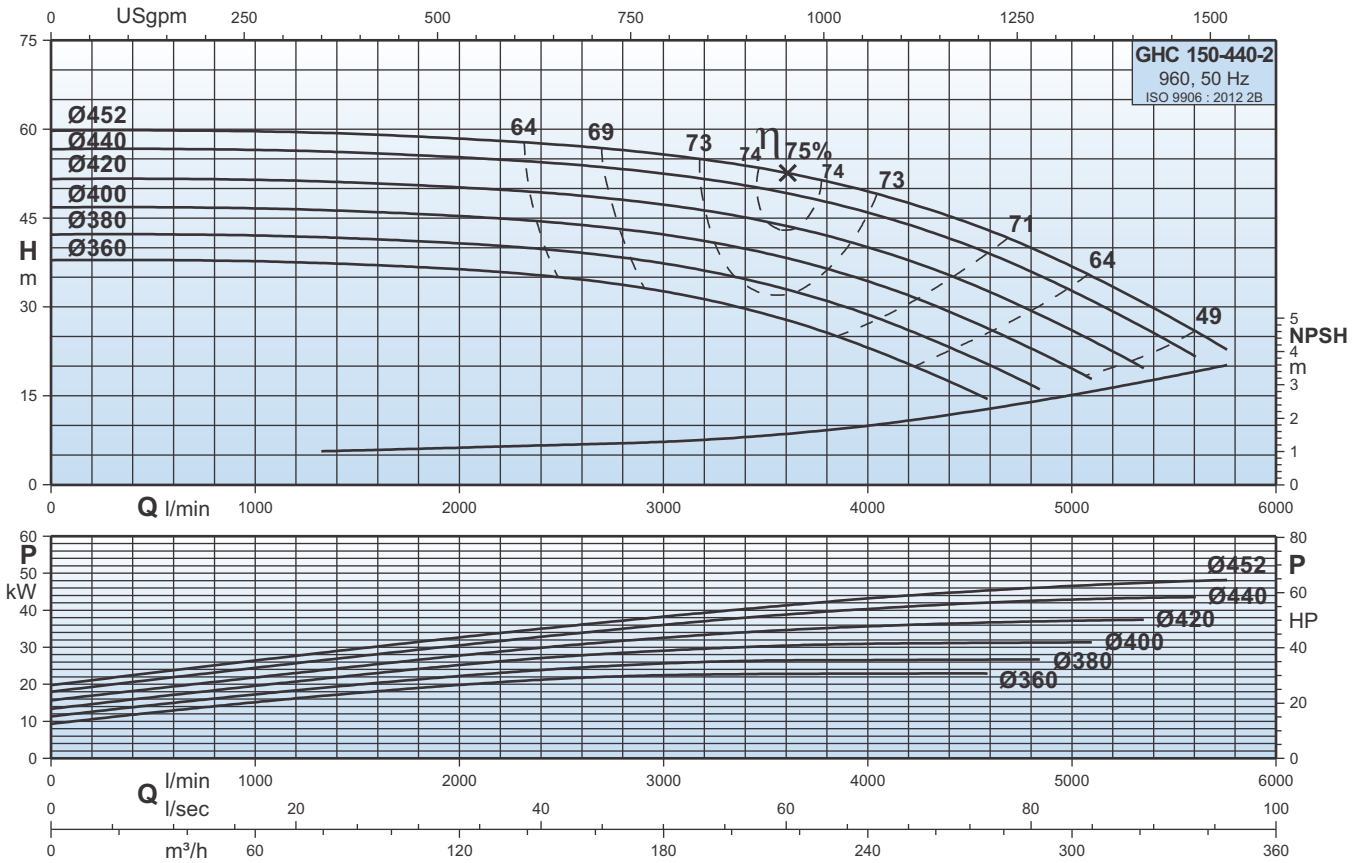

# GHC 150-500

Curvas Características  
Characteristic Curves  
Courbes Caractéristiques

# 960

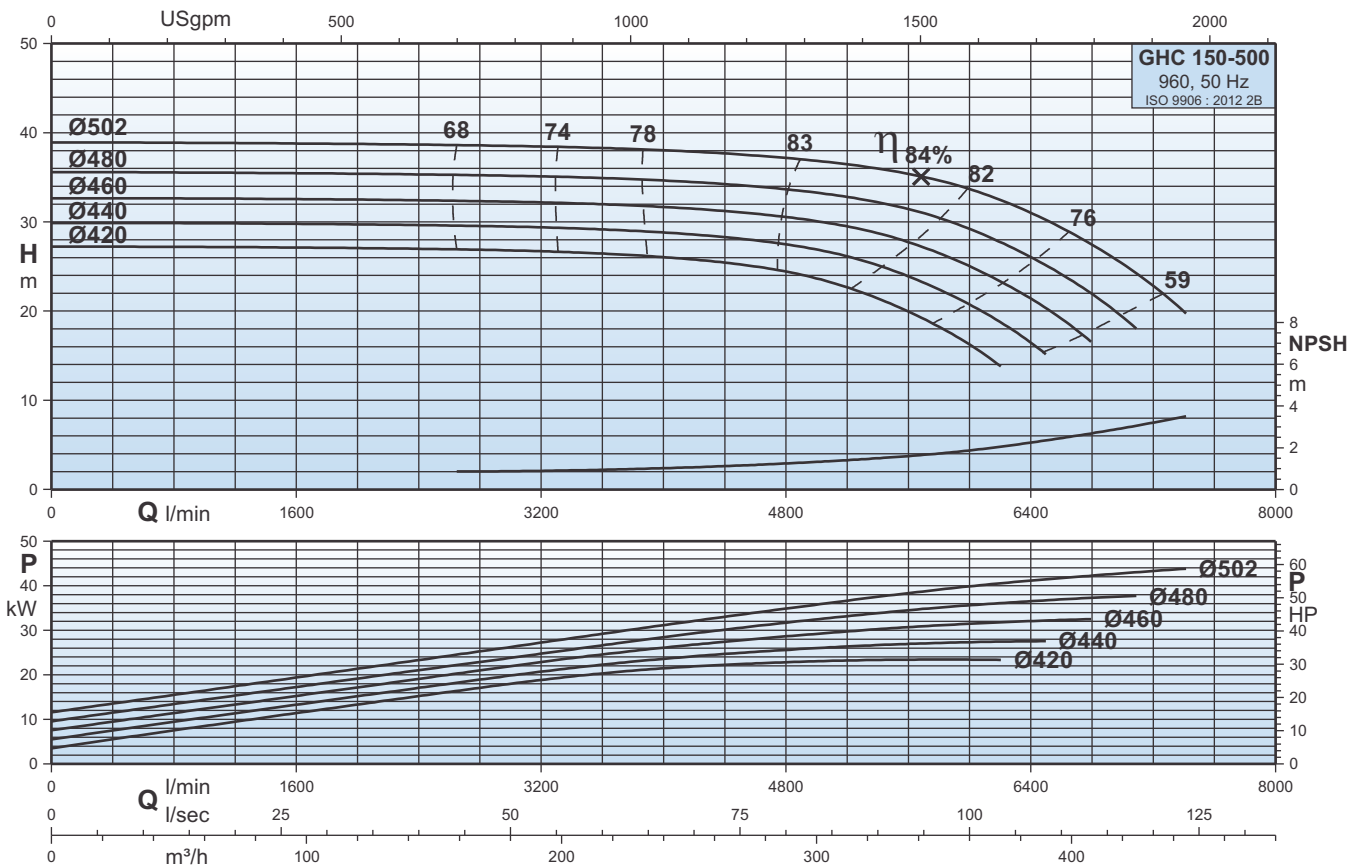

# GHC 200-315

Curvas Características  
Characteristic Curves  
Courbes Caractéristiques

# 960

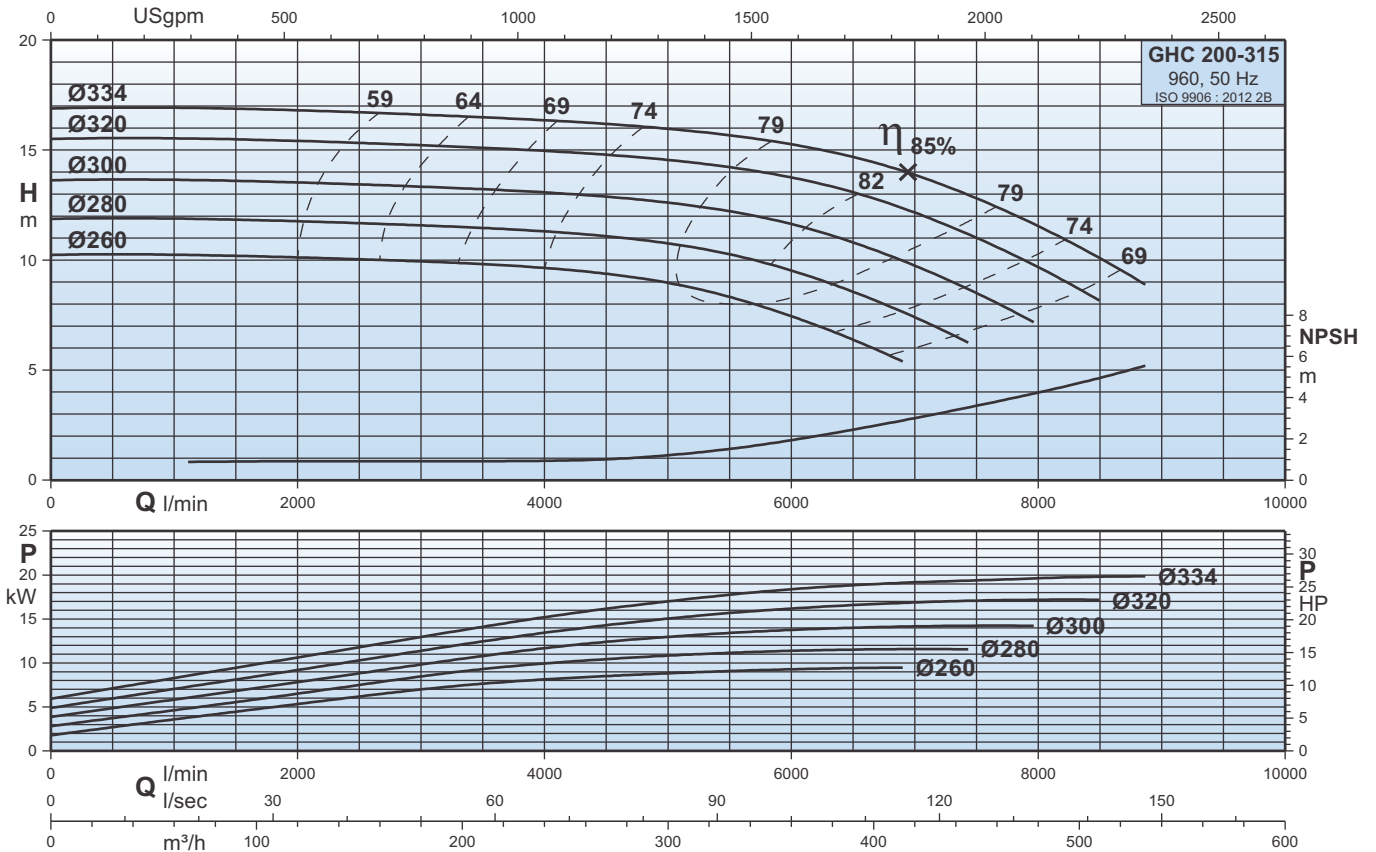

# GHC 200-400

Curvas Características  
Characteristic Curves  
Courbes Caractéristiques

# 960

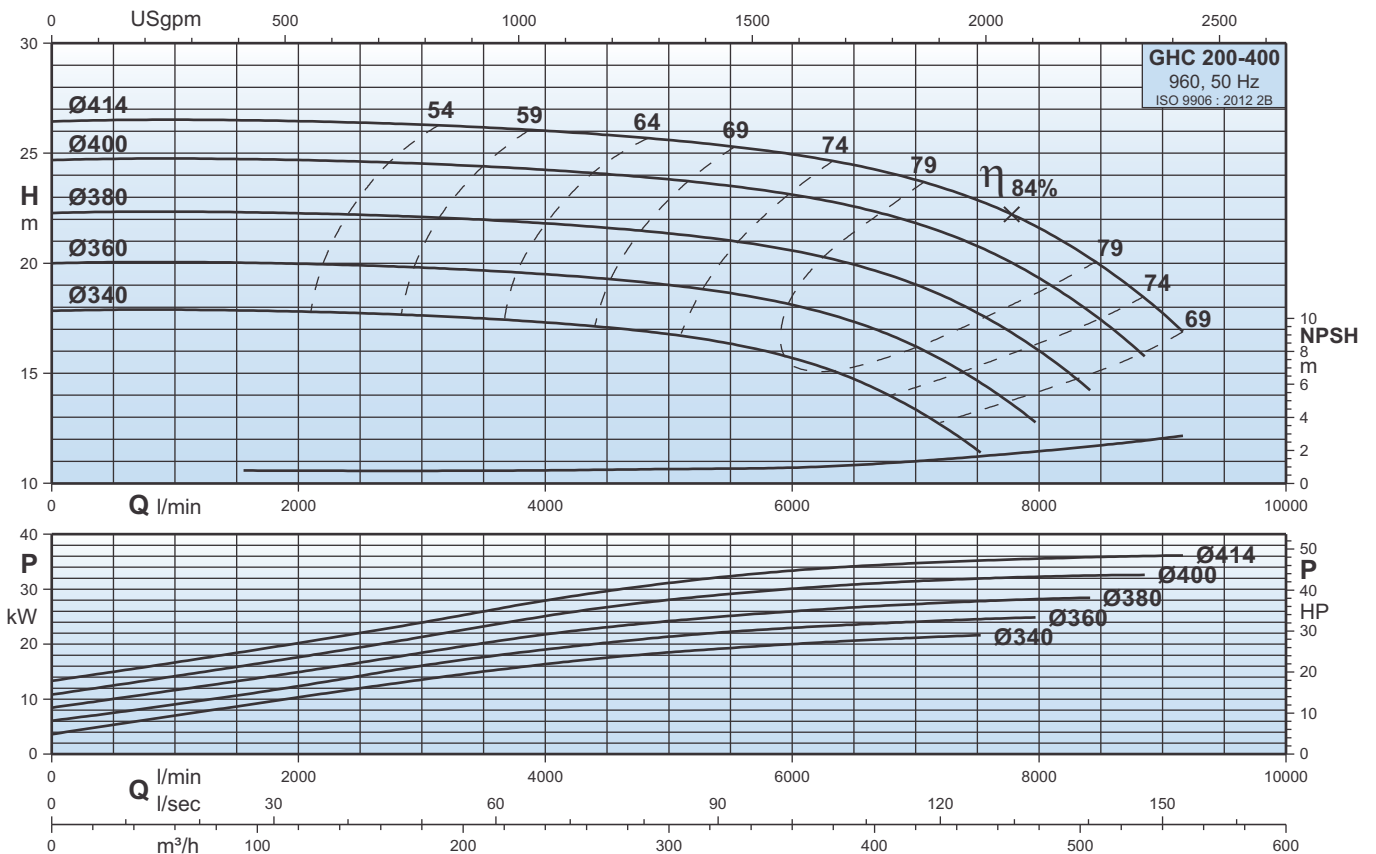

# GHC 200-500

Curvas Características  
Characteristic Curves  
Courbes Caractéristiques

# 960

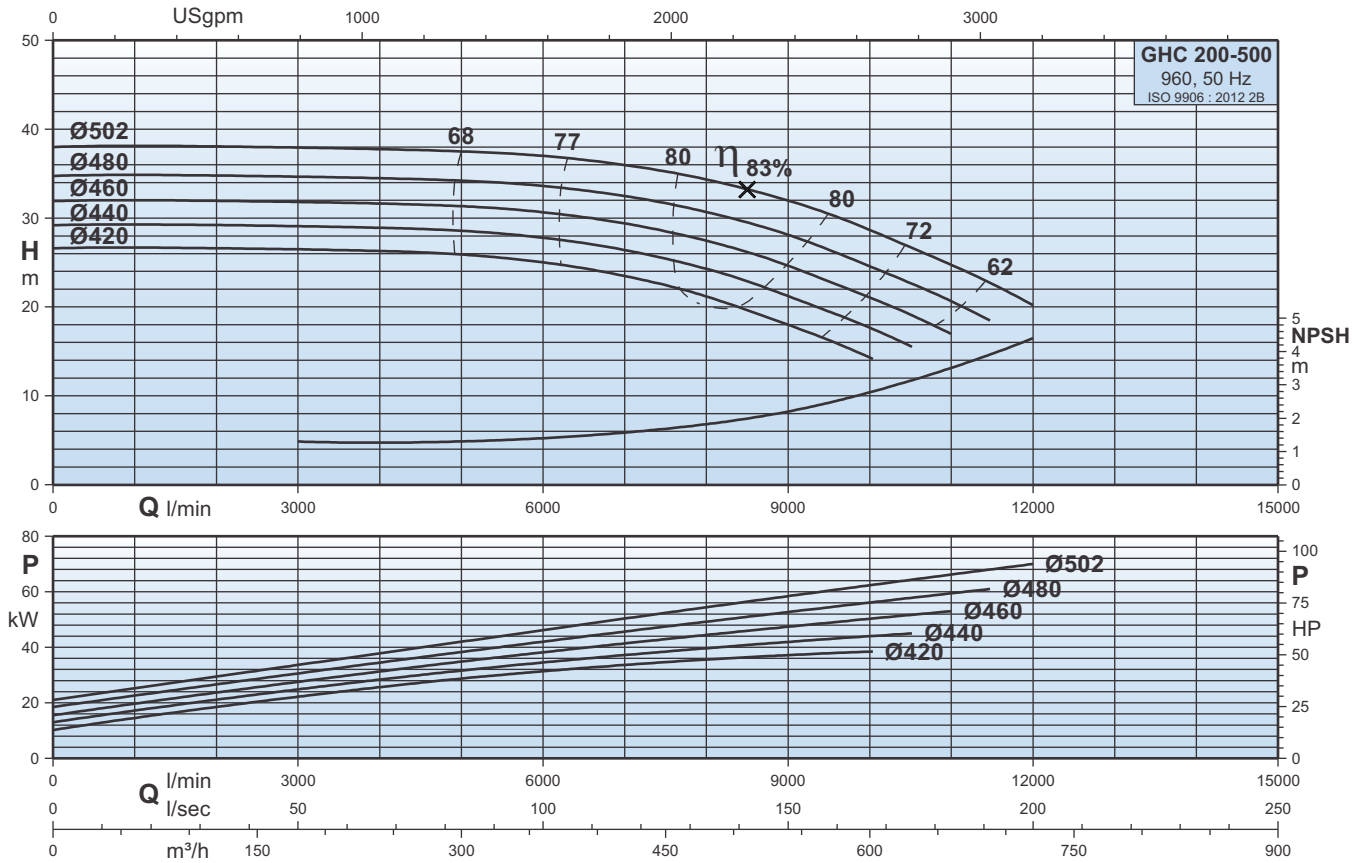

# GHC 250-315

Curvas Características  
Characteristic Curves  
Courbes Caractéristiques

# 960

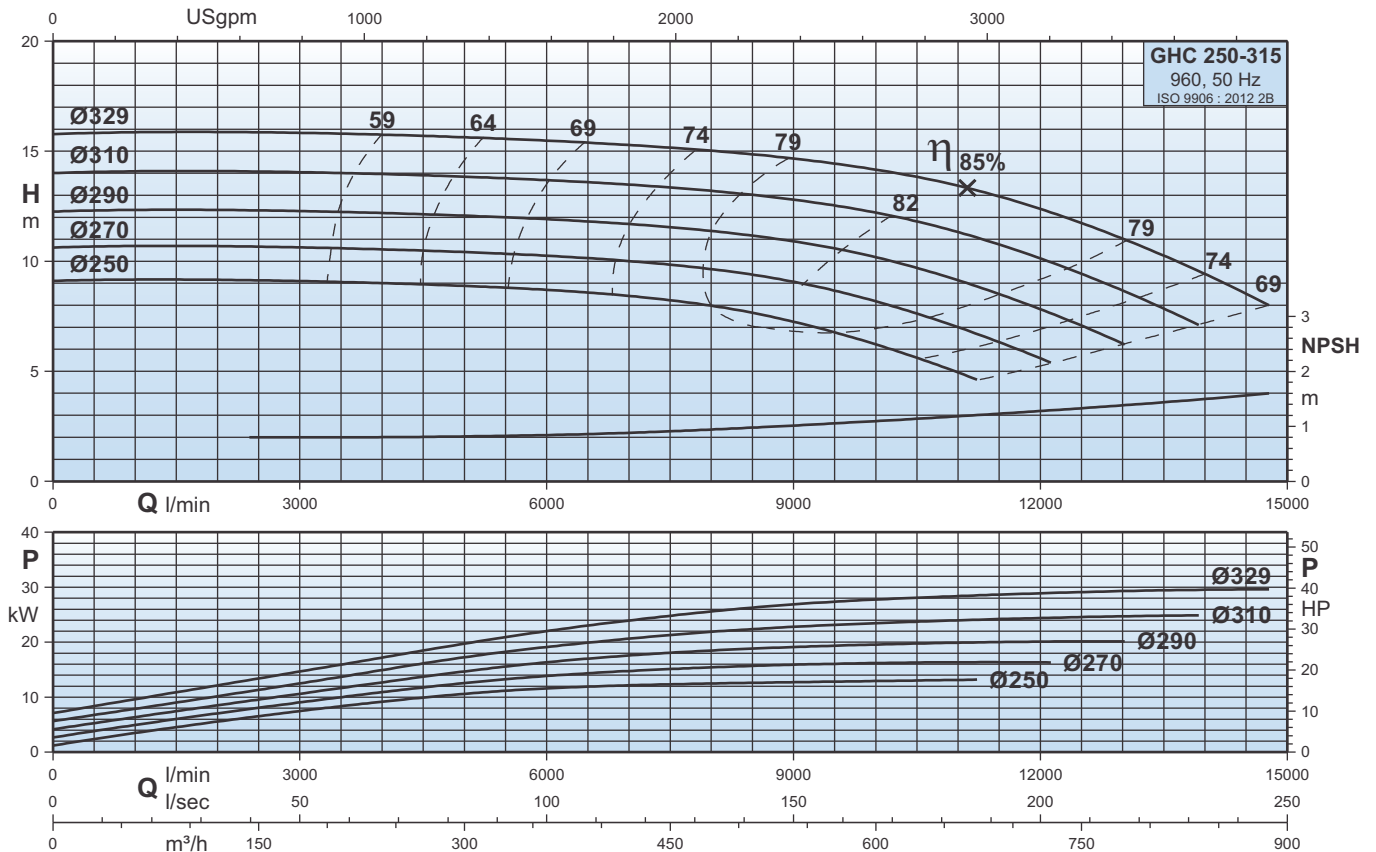

# GHC 250-400

Curvas Características  
Characteristic Curves  
Courbes Caractéristiques

# 960

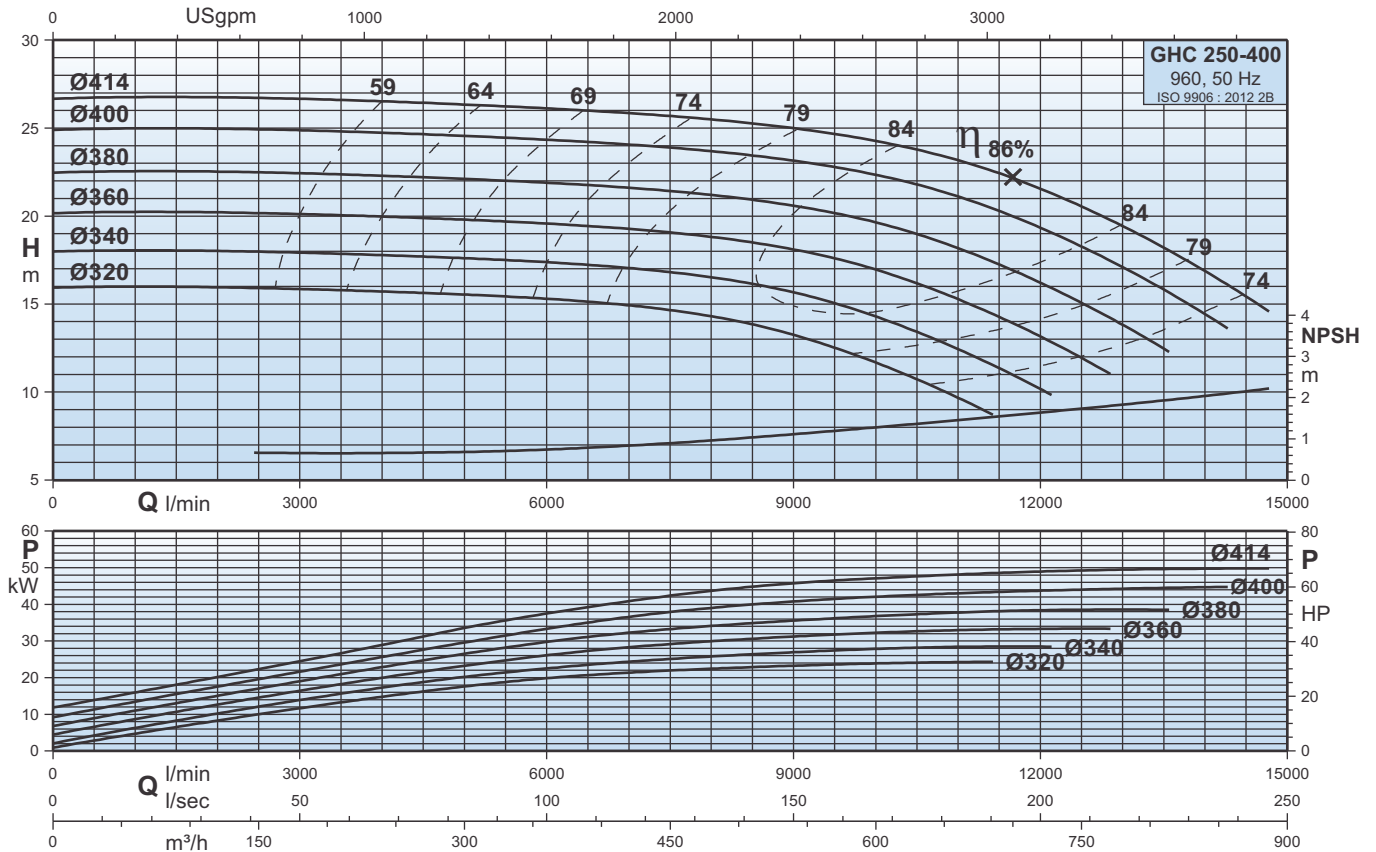

# GHC 250-500

Curvas Características  
Characteristic Curves  
Courbes Caractéristiques

# 960

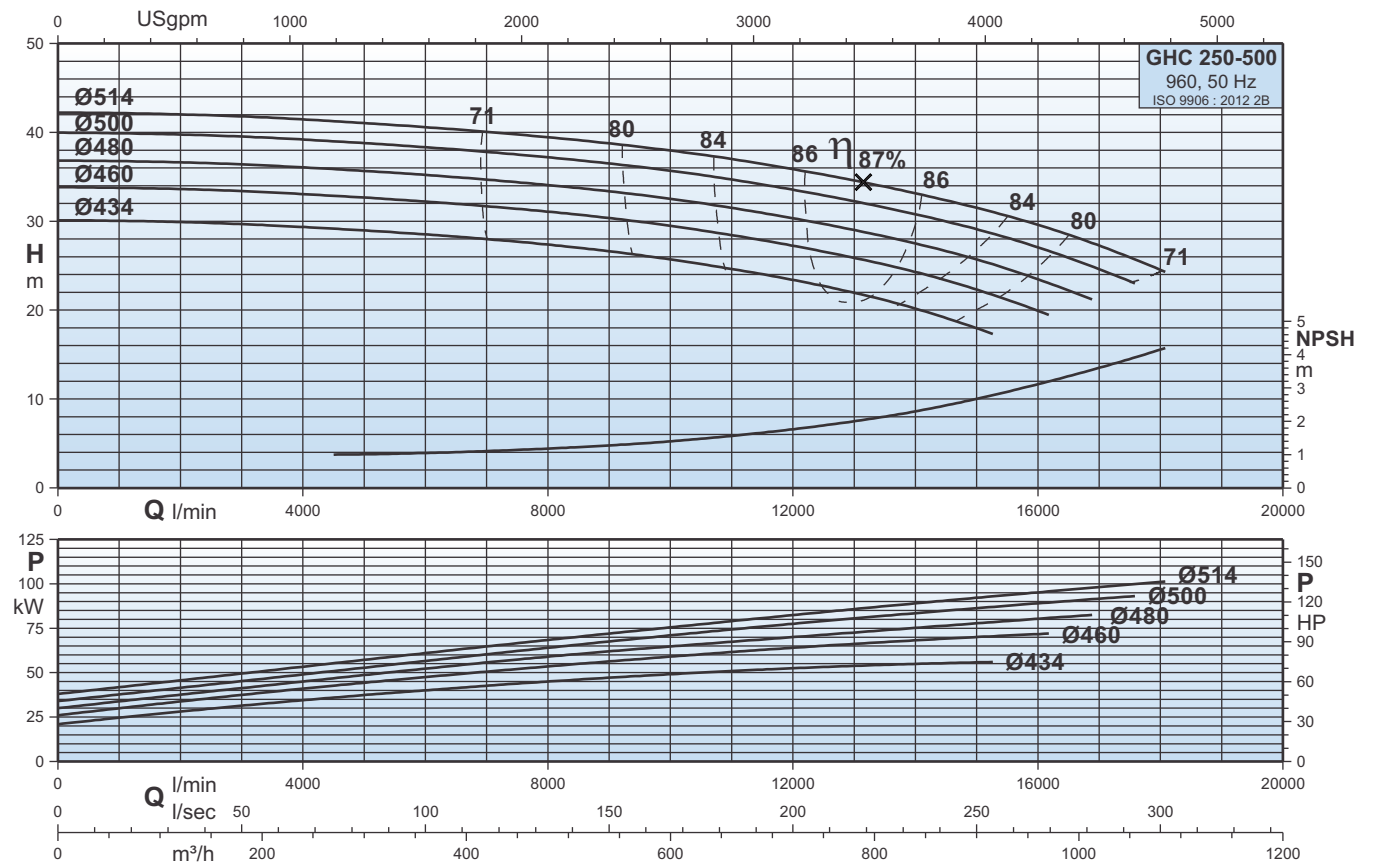

# GHC 300-400

Curvas Características  
Characteristic Curves  
Courbes Caractéristiques

# 960

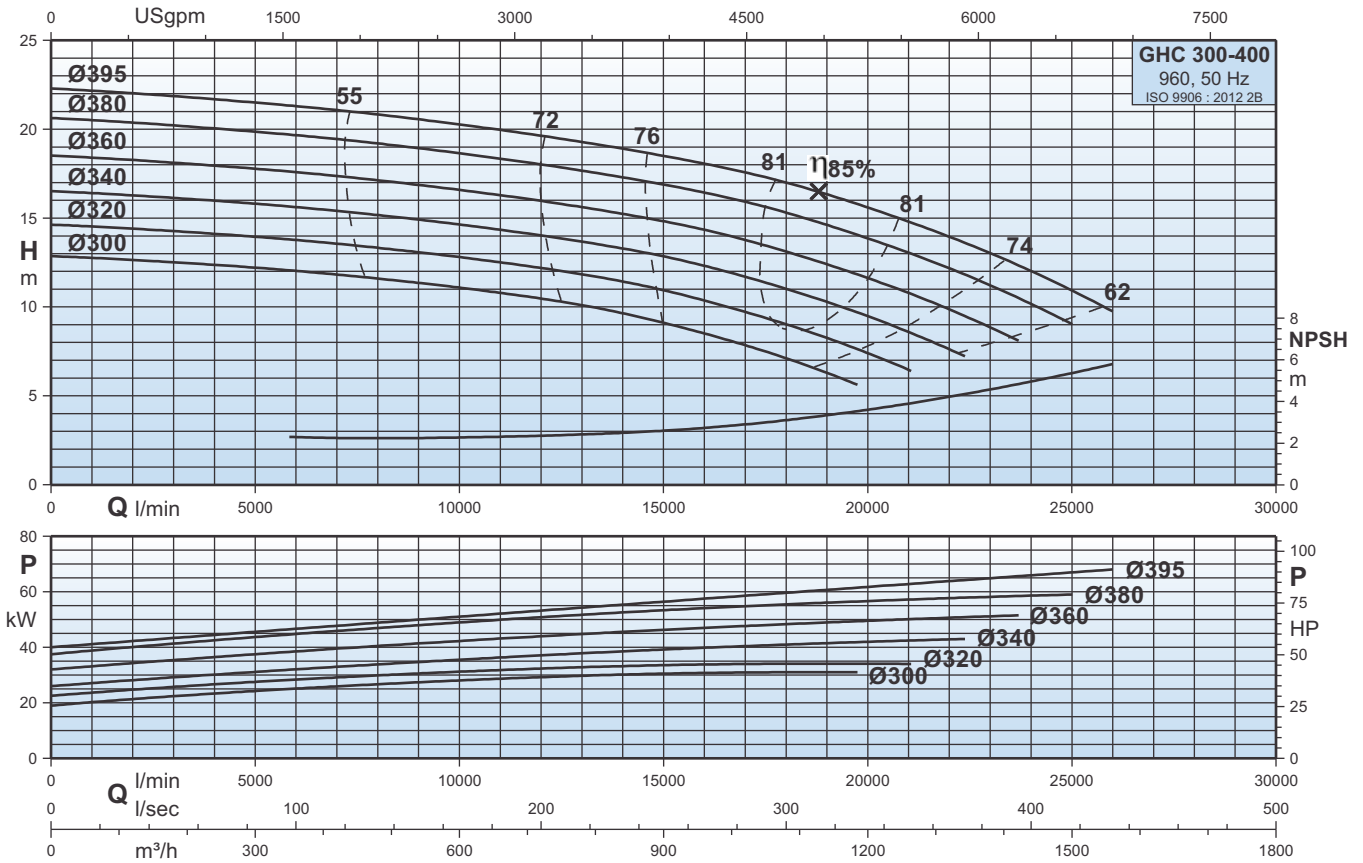

# GHC 400-450

Curvas Características  
Characteristic Curves  
Courbes Caractéristiques

# 960

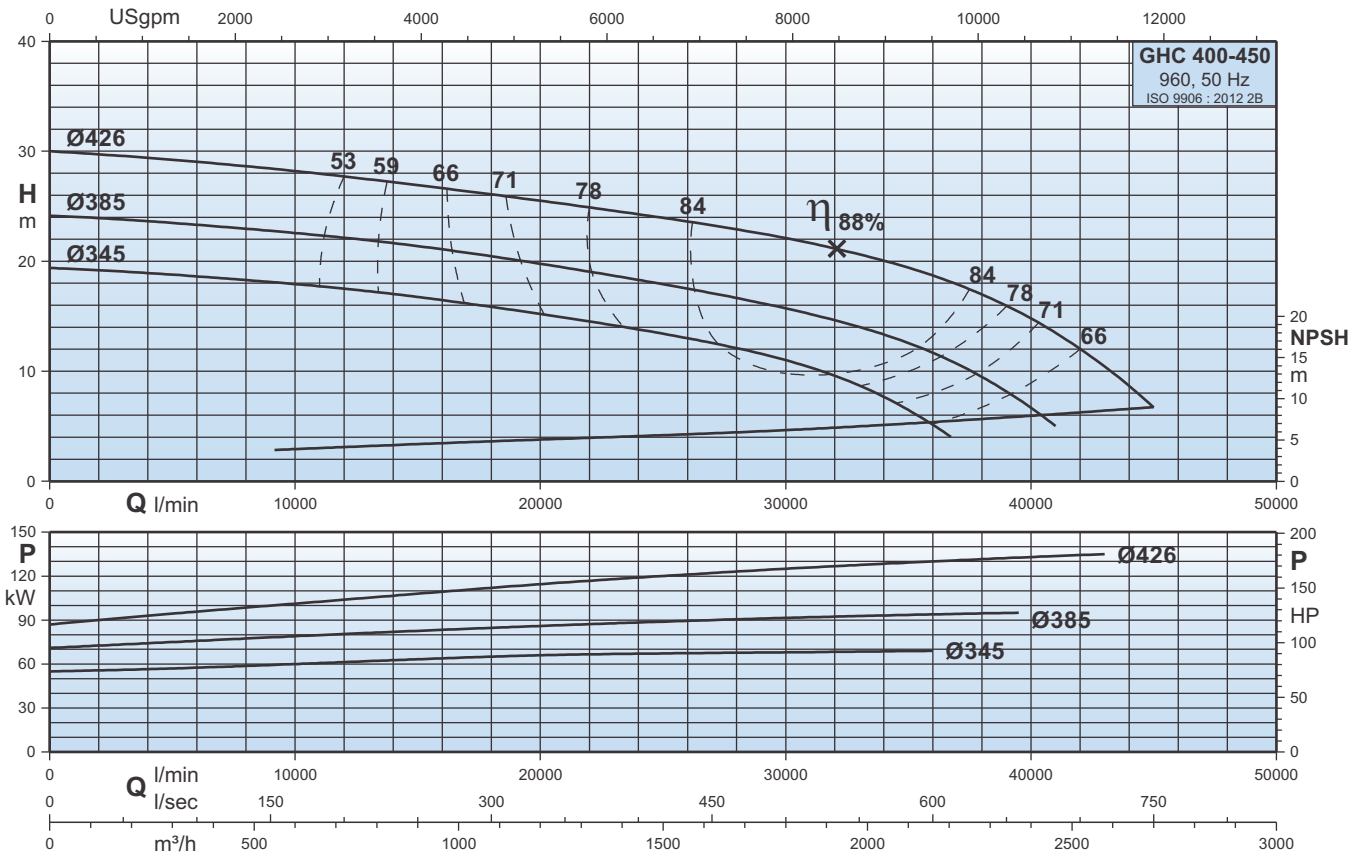



**Dimensiones y pesos**  
**Dimensions and Weights**  
**Dimensions et poids**

**960**

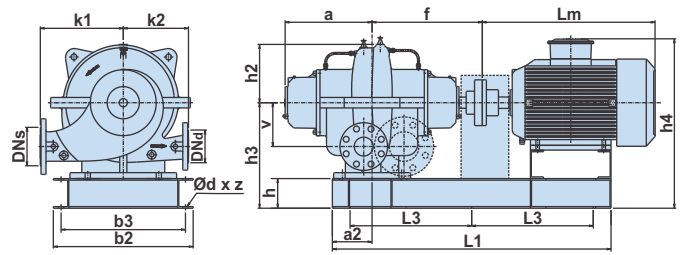
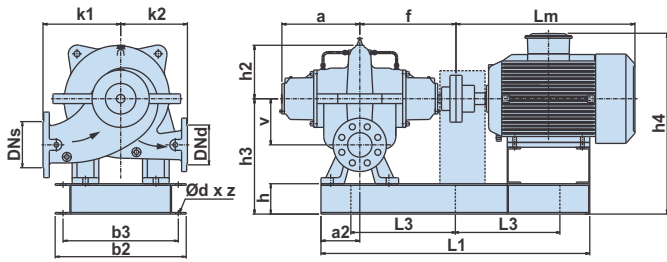

**GHC 150-315, GHC 150-400, GHC 150-500,  
 GHC 200-315, GHC 200-400**

**GHC 100-400-2, GHC 125-400-2, GHC 150-440-2**

	GHC 100-400-2				GHC 125-400-2				GHC 150-315				GHC 150-400					
<b>P<sub>2</sub></b> [kW]	11	15	18,5	22	18,5	22	30	37	4	5,5	7,5	9,3	11	15	15	18,5	22	
[HP]	15	20	25	30	25	30	40	50	5,5	7,5	10	12,5	15	20	20	25	30	
<b>Carcasa/Frame/Armature</b>	160L	180L	200L	200L	200L	200L	225M	250M	132S	132M	160M	160M	160L	180L	180L	200L	200L	
<b>PN</b> [bar]	16	16	16	16	16	16	16	16	16	16	16	16	16	16	16	16	16	
<b>DN<sub>s</sub></b> [mm]	125	125	125	125	150	150	150	150	200	200	200	200	200	200	200	200	200	
<b>DN<sub>d</sub></b> [mm]	100	100	100	100	125	125	125	125	150	150	150	150	150	150	150	150	150	
<b>a</b> [mm]	389	389	389	389	418	418	418	418	352	352	352	352	352	352	374	374	374	
<b>a<sub>2</sub></b> [mm]	163	163	163	163	175	175	175	175	193	193	193	193	193	193	195	195	195	
<b>f</b> [mm]	497	497	497	497	525	525	525	525	452	452	452	452	452	452	482	482	482	
<b>k<sub>1</sub></b> [mm]	405	405	405	405	480	480	480	480	400	400	400	400	400	400	425	425	425	
<b>k<sub>2</sub></b> [mm]	325	325	325	325	335	335	335	335	310	310	310	310	310	310	350	350	350	
<b>v</b> [mm]	225	225	225	225	215	215	215	215	180	180	180	180	180	180	210	210	210	
<b>h<sub>2</sub></b> [mm]	282	282	282	282	297	297	297	297	258	258	258	258	258	258	292	292	292	
<b>h<sub>3</sub></b> [mm]	500	500	500	500	505	505	505	505	500	500	500	500	500	500	535	535	535	
<b>h<sub>4</sub></b> [mm]	743	794	808	808	813	813	833	919	692	692	743	743	743	794	829	843	843	
<b>L<sub>m</sub></b> [mm]	641	761	808	808	808	808	884	940	463	501	601	601	643	763	763	810	810	
<b>h</b> [mm]	125	125	125	125	125	125	125	125	125	125	125	125	125	125	125	125	125	
<b>b<sub>2</sub></b> [mm]	630	630	630	630	660	660	660	660	615	615	615	615	615	615	680	680	680	
<b>b<sub>3</sub></b> [mm]	565	565	565	565	595	595	595	595	550	550	550	550	550	550	615	615	615	
<b>L<sub>1</sub></b> [mm]	1158	1202	1238	1238	1278	1278	1344	1398	979	1117	1102	1102	1144	1189	1222	1256	1256	
<b>L<sub>3</sub></b> [mm]	504	526	544	544	564	564	597	624	414	433	476	476	497	520	536	553	553	
<b>Ød x z</b>	22 x 6	22 x 6	22 x 6	22 x 6	22 x 6	22 x 6	22 x 6	22 x 6	22 x 6	22 x 6	22 x 6	22 x 6	22 x 6	22 x 6	22 x 6	22 x 6	22 x 6	
<b>Peso neto</b> Net weight Poids net	[kg]	558	588	661	677	780	791	868	968	466	488	520	526	543	633	633	686	698
<b>Peso bruto</b> Gross weight Poids brut	[kg]	681	711	784	800	955	966	1043	1160	591	619	656	662	682	776	789	849	866
<b>Volumen bruto</b> Gross volume Volume brut	[m <sup>3</sup> ]	1,558	1,670	1,713	1,713	1,974	1,974	2,053	2,242	1,258	1,291	1,380	1,380	1,417	1,524	1,801	1,849	1,849

	GHC 150-440-2					GHC 150-500				GHC 200-315				GHC 200-400				
<b>P<sub>2</sub></b> [kW]	22	30	37	45	55	22	30	37	45	9,3	11	15	18,5	22	22	30	37	
[HP]	30	40	50	60	75	30	40	50	60	12,5	15	20	25	30	30	40	50	
<b>Carcasa/Frame/Armature</b>	200L	225M	250M	280S	280M	200L	225M	250M	280S	160M	160L	180L	200L	200L	200L	225M	250M	
<b>PN</b> [bar]	16	16	16	16	16	16	16	16	16	16	16	16	16	16	16	16	16	
<b>DN<sub>s</sub></b> [mm]	200	200	200	200	200	200	200	200	200	250	250	250	250	250	250	250	250	
<b>DN<sub>d</sub></b> [mm]	150	150	150	150	150	150	150	150	150	200	200	200	200	200	200	200	200	
<b>a</b> [mm]	462	462	462	462	462	386	386	386	386	405	405	405	405	405	406	406	406	
<b>a<sub>2</sub></b> [mm]	175	175	175	175	175	201	201	201	201	230	230	230	230	230	200	200	200	
<b>f</b> [mm]	570	570	570	570	570	493	493	493	493	513	513	513	513	513	515	515	515	
<b>k<sub>1</sub></b> [mm]	450	450	450	450	450	475	475	475	475	450	450	450	450	450	485	485	485	
<b>k<sub>2</sub></b> [mm]	390	390	390	390	390	425	425	425	425	375	375	375	375	375	420	420	420	
<b>v</b> [mm]	240	240	240	240	240	255	255	255	255	235	235	235	235	235	230	230	230	
<b>h<sub>2</sub></b> [mm]	461	461	461	461	461	330	330	330	330	287	287	287	287	287	313	313	313	
<b>h<sub>3</sub></b> [mm]	566	566	566	566	566	580	580	580	580	590	590	590	590	590	590	590	590	
<b>h<sub>4</sub></b> [mm]	874	894	980	1011	1011	888	908	994	1025	833	833	884	898	898	898	918	1004	
<b>L<sub>m</sub></b> [mm]	808	884	940	1027	1027	810	886	942	1029	601	643	763	810	810	898	886	942	
<b>h</b> [mm]	125	125	125	125	125	125	125	125	125	125	125	125	125	125	125	125	125	
<b>b<sub>2</sub></b> [mm]	660	660	660	680	680	770	770	770	770	710	710	710	710	710	744	744	744	
<b>b<sub>3</sub></b> [mm]	595	595	595	615	615	705	705	705	705	645	645	645	645	645	679	679	679	
<b>L<sub>1</sub></b> [mm]	1324	1390	1442	1482	1532	1273	1340	1393	1481	1200	1242	1288	1322	1322	1294	1361	1414	
<b>L<sub>3</sub></b> [mm]	587	620	646	666	691	561	595	621	666	525	546	569	586	586	721	605	632	
<b>Ød x z</b>	22 x 6	22 x 6	22 x 6	22 x 6	22 x 6	22 x 6	22 x 6	22 x 6	22 x 6	22 x 6	22 x 6	22 x 6	22 x 6	22 x 6	22 x 6	22 x 6	22 x 6	
<b>Peso neto</b> Net weight Poids net	[kg]	986	1066	1166	1352	1383	864	896	988	1106	639	656	746	797	809	871	951	1051
<b>Peso bruto</b> Gross weight Poids brut	[kg]	1180	1269	1374	1594	1625	1039	1095	1187	1316	800	820	916	975	992	1065	1154	1259
<b>Volumen bruto</b> Gross volume Volume brut	[m <sup>3</sup> ]	2,562	2,660	2,732	2,844	2,844	2,286	2,380	2,520	2,698	1,873	1,920	2,054	2,107	2,107	2,445	2,430	2,607



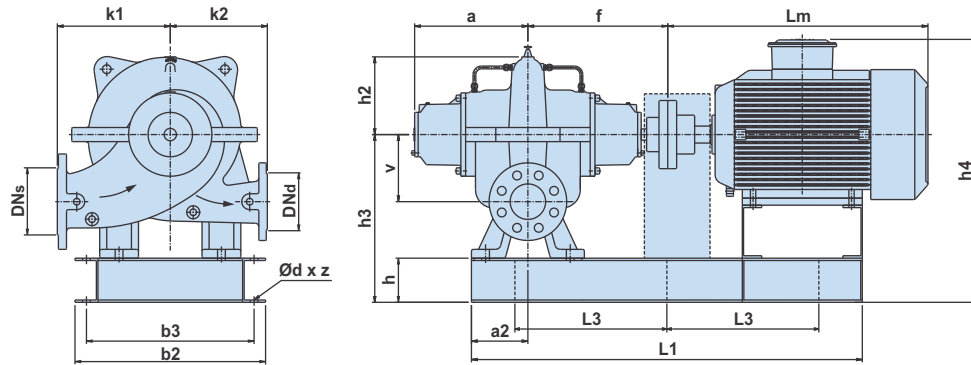

	GHC 200-500				GHC 250-315				GHC 250-400				GHC 250-500				
<b>P2</b> [kW]	37	45	55	75	15	18,5	22	30	30	37	45	55	55	75	90	110	
[HP]	50	60	75	100	20	25	30	40	40	50	60	75	75	100	120	150	
Carcasa/Frame/Armature	250M	280S	280M	315S	180L	200L	200L	225M	225M	250M	280S	280M	280M	315S	315M	315L	
<b>PN</b> [bar]	16	16	16	16	16	16	16	16	16	16	16	16	16	16	16	16	
<b>DNs</b> [mm]	250	250	250	250	300	300	300	300	300	300	300	300	300	300	300	300	
<b>DNd</b> [mm]	200	200	200	200	250	250	250	250	250	250	250	250	250	250	250	250	
<b>a</b> [mm]	470	470	470	470	442	442	442	442	439	439	439	439	495	495	495	495	
<b>a2</b> [mm]	238	238	238	238	260	260	260	260	260	260	260	260	260	260	260	260	
<b>f</b> [mm]	605	605	605	605	551	551	551	551	548	548	548	548	634	634	634	634	
<b>k1</b> [mm]	525	525	525	525	525	525	525	525	550	550	550	550	600	600	600	600	
<b>k2</b> [mm]	510	510	510	510	450	450	450	450	475	475	475	475	575	575	575	575	
<b>v</b> [mm]	270	270	270	270	265	265	265	265	275	275	275	275	275	275	275	275	
<b>h2</b> [mm]	350	350	350	350	326	326	326	326	343	343	343	343	379	379	379	379	
<b>h3</b> [mm]	630	630	630	630	665	665	665	665	675	675	675	675	675	675	675	675	
<b>h4</b> [mm]	1044	1075	1075	1157	959	973	973	993	1003	1089	1120	1120	1120	1202	1202	1202	
<b>Lm</b> [mm]	942	1029	1029	1212	763	810	810	886	886	942	1029	1029	1029	1212	1322	1322	
<b>h</b> [mm]	125	125	125	125	125	125	125	125	125	125	125	125	125	125	125	125	
<b>b2</b> [mm]	760	760	760	768	800	800	800	800	870	870	870	870	975	975	975	975	
<b>b3</b> [mm]	695	695	695	703	735	735	735	735	805	805	805	805	910	910	910	910	
<b>L1</b> [mm]	1542	1631	1631	1721	1355	1390	1390	1457	1454	1507	1595	1595	1681	1772	1882	1882	
<b>L3</b> [mm]	696	740	740	786	603	620	620	653	652	678	723	723	766	811	866	866	
<b>Ød x z</b>	22 x 6	22 x 6	22 x 6	22 x 6	22 x 6	22 x 6	22 x 6	22 x 6	22 x 6	22 x 6	22 x 6	22 x 6	22 x 6	22 x 6	22 x 6	22 x 6	
<b>Peso neto</b> Net weight Poids net	[kg]	1188	1306	1383	1765	918	972	984	1063	1106	1206	1392	1423	1427	1817	1897	2092
<b>Peso bruto</b> Gross weight Poids brut	[kg]	1448	1566	1643	2035	1122	1185	1197	1285	1329	1443	1634	1665	1627	2067	2147	2342
<b>Volumen bruto</b> Gross volume Volume brut	[m³]	3,255	3,469	3,469	3,987	2,712	2,779	2,779	2,887	3,070	3,207	3,420	3,420	4,109	4,705	4,913	4,913

	GHC 300-400				GHC 400-450					
<b>P2</b> [kW]	37	45	55	75	75	90	110	132		
[HP]	50	60	75	100	100	120	150	180		
Carcasa/Frame/Armature	250M	280S	280M	315S	315S	315M	315M	315L		
<b>PN</b> [bar]	16	16	16	16	16	16	16	16		
<b>DNs</b> [mm]	350	350	350	350	450	450	450	450		
<b>DNd</b> [mm]	300	300	300	300	400	400	400	400		
<b>a</b> [mm]	529	529	529	529	625	625	625	625		
<b>a2</b> [mm]	270	270	270	270	400	400	400	400		
<b>f</b> [mm]	665	665	665	665	763	763	763	763		
<b>k1</b> [mm]	625	625	625	625	750	750	750	750		
<b>k2</b> [mm]	460	460	460	460	600	600	600	600		
<b>v</b> [mm]	305	305	305	305	400	400	400	400		
<b>h2</b> [mm]	370	370	370	370	474	474	474	474		
<b>h3</b> [mm]	740	740	740	740	900	900	900	900		
<b>h4</b> [mm]	1154	1185	1185	1267	1427	1427	1427	1427		
<b>Lm</b> [mm]	942	1029	1029	1212	1212	1322	1322	1322		
<b>h</b> [mm]	125	125	125	125	125	125	125	125		
<b>b2</b> [mm]	870	870	870	870	1090	1090	1090	1090		
<b>b3</b> [mm]	805	805	805	805	1025	1025	1025	1025		
<b>L1</b> [mm]	1634	1723	1723	1813	2041	2151	2151	2151		
<b>L3</b> [mm]	742	786	786	832	945	1000	1000	1000		
<b>Ød x z</b>	22 x 6	22 x 6	22 x 6	22 x 6	22 x 6	22 x 6	22 x 6	22 x 6		
<b>Peso neto</b> Net weight Poids net	[kg]	1500	1615	1665	2035	2473	2533	2663	2833	
<b>Peso bruto</b> Gross weight Poids brut	[kg]	1725	1865	1915	2385	2846	2906	3036	3220	
<b>Volumen bruto</b> Gross volume Volume brut	[m³]	3,906	4,128	4,128	4,705	6,807	7,080	7,080	7,080	